

# KEYLESSH3 Installation Instructions

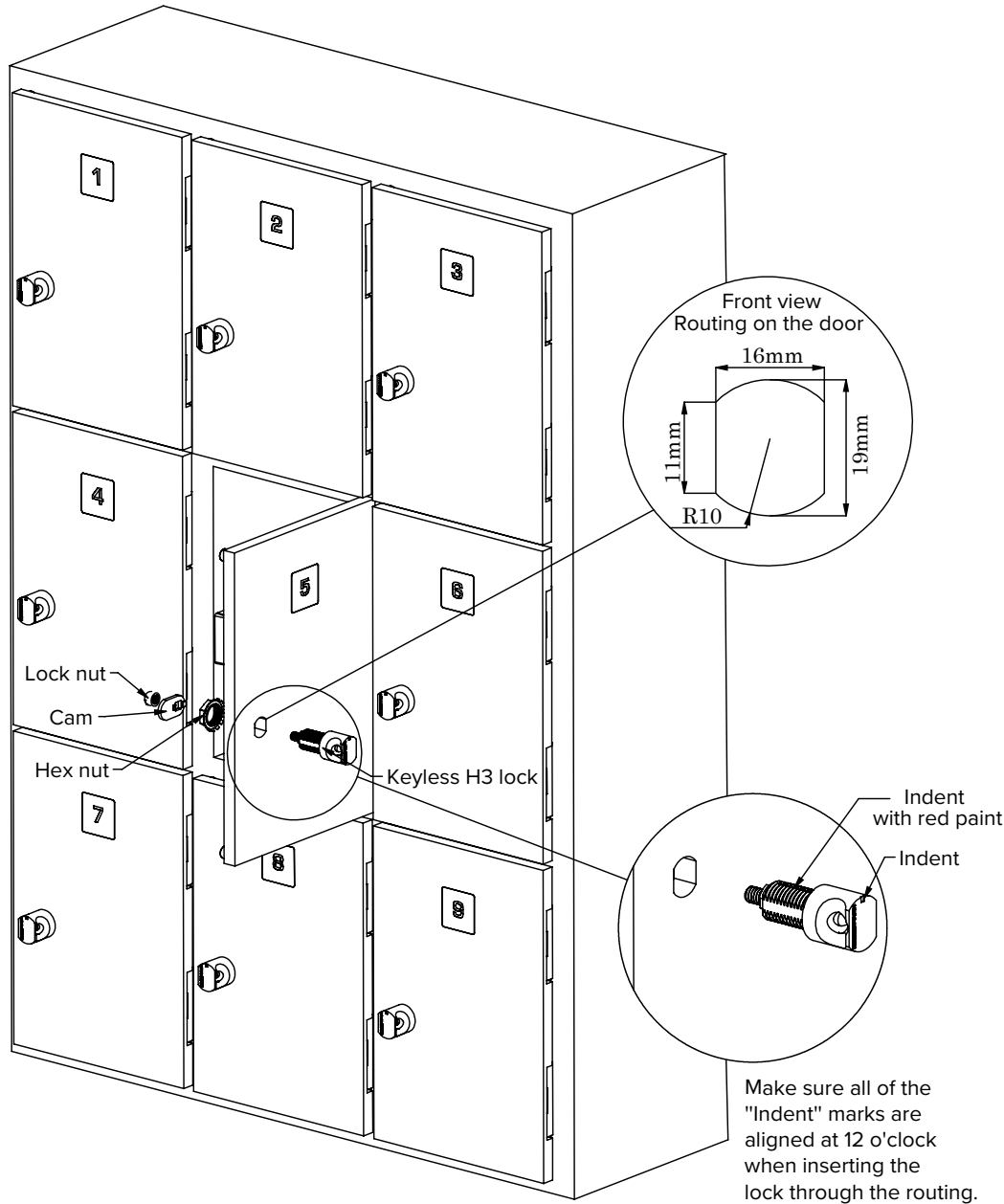

Make sure all of the "Indent" marks are aligned at 12 o'clock when inserting the lock through the routing.

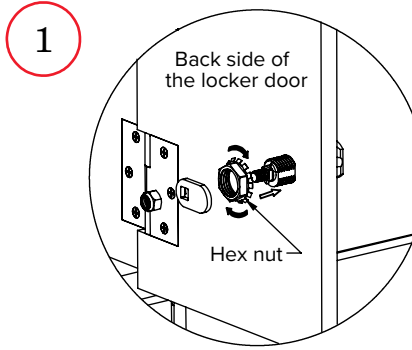

Insert the lock through door routing followed by the hex nut. Tighten the hex nut clockwise and make sure it is securely fastened.

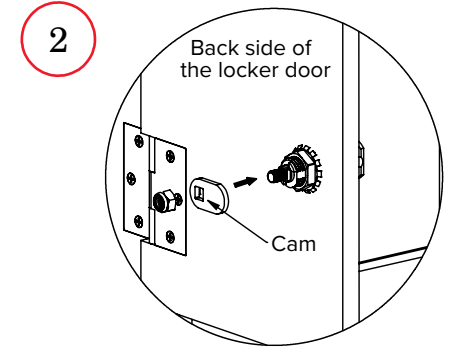

Insert the cam through the cylinder bolt and make sure the cam is facing towards the edge of the door.

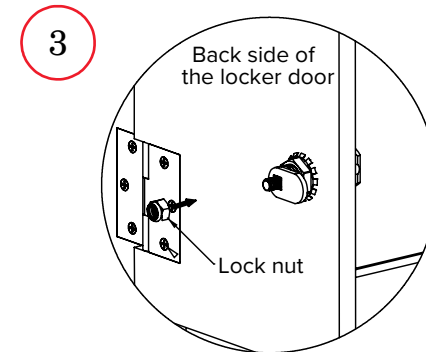

Place the lock nut, tighten the lock nut clockwise and make sure it is securely fastened but not too tight.

## Test the lock after installation

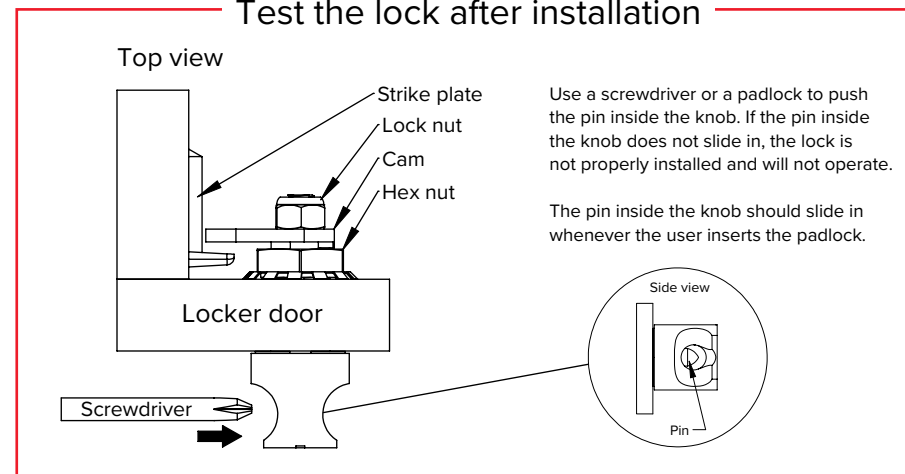

Use a screwdriver or a padlock to push the pin inside the knob. If the pin inside the knob does not slide in, the lock is not properly installed and will not operate.

The pin inside the knob should slide in whenever the user inserts the padlock.