

SERO COAT HOOK

ARCHITECTURAL SPECIFICATIONS



PART NUMBER:
SERO-HOOK-SN

STANDARD FINISH:
SATIN NICKEL



PART NUMBER:
SERO-HOOK-MB

PREMIUM FINISH:
MATTE BLACK
MUNSELL N2/



PART NUMBER:
SERO-HOOK-MW

PREMIUM FINISH:
MATTE WHITE
MUNSELL N9/



PART NUMBER:
SERO-HOOK-SG

PREMIUM FINISH:
SATIN GOLD
PANTONE #871C

10% color discrepancy, and custom pricing options apply.

- Material: Zinc Alloy 5
- Finishes: Satin Nickel, Satin Gold, Matte Black, Matte White
- Satin nickel screws included (quantity: 2)

- When disinfecting, mist with liquid that is at least 70% alcohol solution in order to maintain product integrity

SIDE VIEW

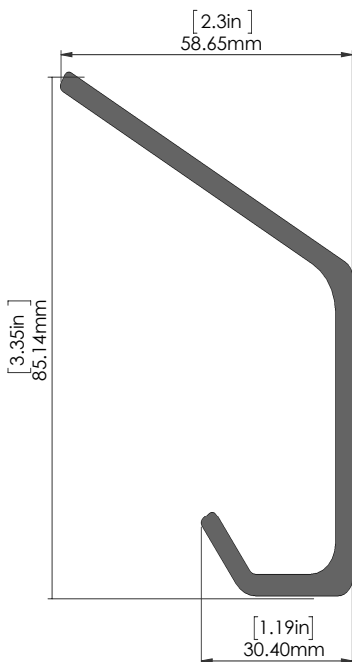

FRONT VIEW

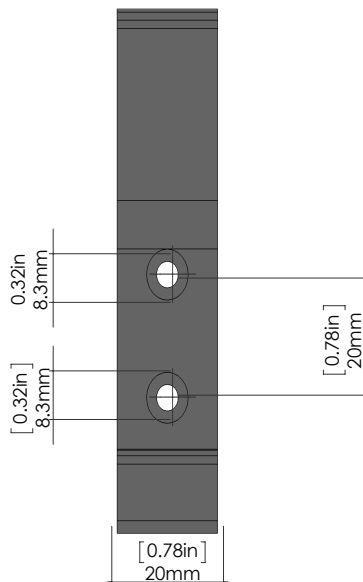

BACK VIEW

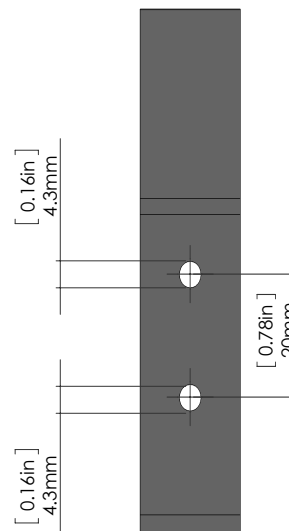

SCREWS

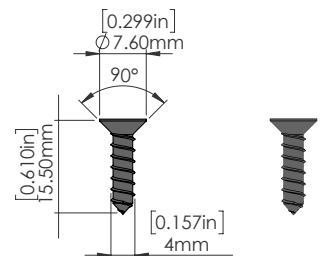

Manufactured By:

KEYLESS.CO

1825 W. Walnut Hill Ln., Suite 102, Irving, TX 75038, USA | +1 972-331-2770 | info@keyless.co | www.keyless.co | V: 12/8/2020